



## A safe route outside.

The EscapeSet for a 2nd escape route  
from Becker.



**BECKER**  
Together it's easier.



## Feel safe in the event of an emergency

A second escape route is now a requirement in an increasing number of buildings and leaving the building through a window or patio door is an easy option. However, solutions that involve the use of electric drives need to be reliable – even in the event of a power cut.

The new EscapeSet from Becker allows users to easily comply with the requirement for an additional escape route. The blinds can be raised easily and quickly in any situation thanks to the crank installed inside the building. This ensures that you can always safely escape outside.

The drive automatically detects its end positions again after using the crank, without it having to be recalibrated. The crank is only used to turn the drive when operating it for the first time during installation. Afterwards, it is discretely and securely stored in a holder next to the window.



### Ready to use in the event of an emergency

Have all of the blinds been lowered and the route to the front door is blocked by fire? And have you also lost power to the drive? This is where the EscapeSet comes into play. The crank allows you to raise the blinds quickly and easily.

The EscapeSet ensures that the building is well-equipped to handle an emergency situation and gives its residents a feeling of security.





## Highlights of the EscapeSet

---

- Quick opening even in the event of a loss of power
- Optimal gear ratio between the crank and drive
- The crank only turns with the drive when operating it for the first time during installation
- Drive with sensitive obstacle and blockage detection
- The drive automatically detects its end positions, even after it has been operated with the crank
- Suitable for use with top-mounted roller shutters or lintel box roller shutters

## Contents of the EscapeSet

---

- Drive with electronic limit switch 12 Nm, depending on the set
- C-Plug (3 m)
- Wall bearing, depending on the set
- Mini strip or mounting pin, depending on the set
- Roller shutter escape drive adapter set (contains ring, output shaft adapter, drive adapter)
- Roller shutter escape hand crank set, depending on the set for top-mounted roller shutters or lintel box roller shutters

## Important information on installation and sale!

---

Due to patent agreements, the delivery of the E22 drive type is not permitted in roller shutter applications in conjunction with escape door solutions in the areas of houses, modular buildings and commercial properties in solid timber and/or timber frame construction.



**BECKER**

Suitable for:

- Roller shutters in top-mounted elements

## EscapeSet top-mounted 12 Nm

4007 000 030 0

Consisting of:

- Drive R12-17-E22 (2010 120 176 0)
- C-Plug 3 m (2010 270 380 0)
- Wall bearing with catch (4930 300 382 0)
- Mini bracket (4930 300 536 0)
- Roller shutter escape catch set (4007 200 066 0) includes ring S60L, output shaft adapter, driver S60
- Roller shutter escape hand crank set top-mounted element (4007 200 067 0) includes bevel gear for 60 mm square shaft, spherical plain bearing with 45° SW6 square rod, 1m joint crank, crank rod holder

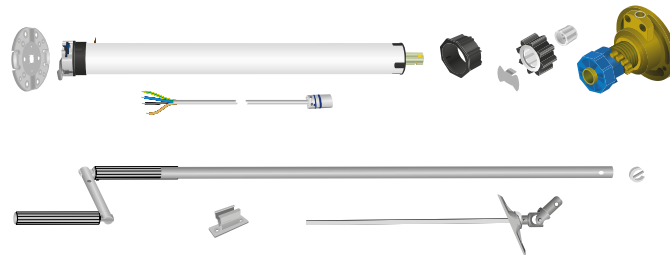

Suitable for:

- Roller shutters in lintel box

## EscapeSet new building 12 Nm

4007 000 032 0

Consisting of:

- Drive R12-17-E22 (2010 120 176 0)
- C-Plug 3 m (2010 270 380 0)
- Universal wall bearing (4930 200 005 0)
- Round pin (4930 300 159 0)
- Roller shutter escape catch set (4007 200 066 0) includes ring S60L, output shaft adapter, driver S60
- Roller shutter escape hand crank set new building kit (4007 200 071 0) includes bevel gear for 60 mm square shaft, spherical plain bearing with square rod 90° SW6, joint crank 1m, crank rod holder

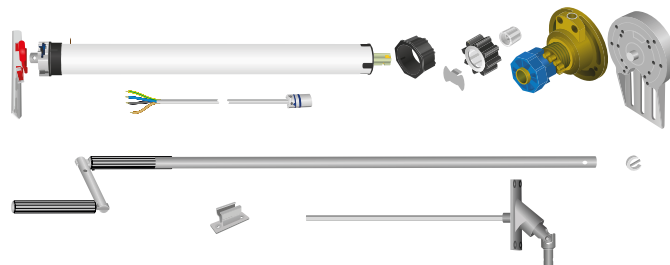

- ▶ Universal gearbox holder (4930 300 698 0) can be ordered as an optional accessory.